

## LL AQUA SPOT DC 12V

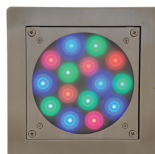

### COMPLIMENTS ON YOUR PURCHASE!

All dimensions are in millimeters

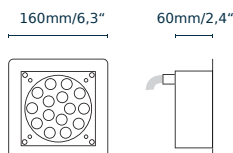

#### Following items are included:

- LL AQUA SPOT DC 12V
- User manual

1 pc.  
1 pc.

#### Additional items needed:

- DRIVER
- DC power supply 12V
- Controller compatible with DMX

#### Content:

### 01 SAFETY INFORMATION

- 01.1 Risk of eyes damage
- 01.2 Protection from electric shock
- 01.3 Fire prevention

### 02 PRODUCT SPECIFICATION

- 02.1 Technical Specification

### 03 INSTALLATION

- 03.1 Unpacking
- 03.2 Physical installation
- 03.3 Electrical installation
  - 03.3.1 Connecting to AC/DC power supply
  - 03.3.2 Connecting to LL DRIVER for intensity/colour control

### 04 MAINTENANCE

#### ENVIRONMENT



Do not throw away the appliance with the normal household waste at the end of its life, but hand it in at an official collection point for recycling. By doing this, you help to preserve the environment.

### 01 SAFETY INFORMATION



#### WARNING!!!

Carefully read before installing, powering or servicing.  
Nothing to do if anything misunderstand! Installation can be done only by a qualified professional in accordance with relevant local codes.

#### 01.1 Risk of eyes damage

- Do not look directly into LED lamps.
- Do not look into light beam from a distance of less than 40 cm (16 inches)



#### 01.2 Protection from electric shock

- Shut down power before installation or maintenance.
- Luminaries, Driver and recommended power supply must be installed by a qualified professional in accordance with relevant local codes. Only acceptable source of power and frequency that complies with local building and electrical codes to use.
- Do not use or do not connect the products if the power cable, power plug or fixtures are any way damaged, wet, or if they are overheating.
- Do not modify, alter, or attempt to service the LeaderLight appliance. Doing so will void the warranty.
- Before removing or installing any cover or part of appliance disconnect from power.



**Operation only with DC 12V source!**  
**By using a high voltage AC power supply - danger of electric shock!**

#### 01.3 Fire prevention

- Follow all safety consideration.
- Thermostatic switches or fuses never to bypass.
- Device never shield. Around the axis of the fitting (180°) must be maintained space for cooling.
- LEDs never direct cover with filters or other materials.
- Allowing max. ambient temperature is 40°C (104°F).



### 02 PRODUCT SPECIFICATION

#### 02.1 Technical Specification

<b>Lamp type:</b>	18 x LED
<b>Lifetime:</b>	Long 50 000 hrs 70% degradation
<b>Optic:</b>	Standard: 15° On request: 30°, 40°, 60°
<b>Control data Input:</b>	monochrome: 1 channel 12V dimming, color: 3 channels 12V dimming
<b>Input power:</b>	max. 25W
<b>Power connection:</b>	PWM 12V
<b>Net weight:</b>	max. 3kg
<b>IP:</b>	IP68
<b>Ambient temp. (Ta):</b>	Maximum +40°C (104°F)
<b>Cooling:</b>	Conventional
<b>Materials and finish:</b>	Stainless steel
<b>Installation:</b>	Built in with back box

### 03 INSTALLATION

#### 03.1 Unpacking

- Unpack carefully.
- This is electronic equipment and should be handled carefully.
- Damaged delivered package or if are any mechanical parts broken – it must be claim immediately by the transport company. Photo pictures as evidence are valuable for future claim.

#### 03.2 Physical installation

- Loading capacity of bearing area has to be at least 10 times the weight of all device clusters (luminaries, clamps, cables, ...).
- Hairbreadth from combustible materials is 0,5m.

#### Installation



Back box

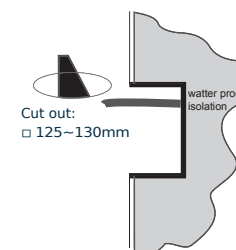

Cut out:  
□ 125~130mm

1.1.1. Cut a square hole for back box (min 125 mm (4,92") - max 130 mm (5,12")) depth min 90 - 100 mm (3,54" - 3,94").

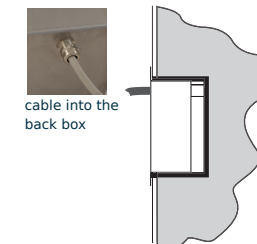
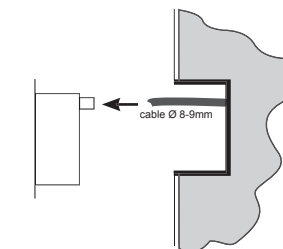

cable into the back box

1.1.2. The cable put through the gland in the back box. Fix the back box to surface.



LL AQUA SPOT

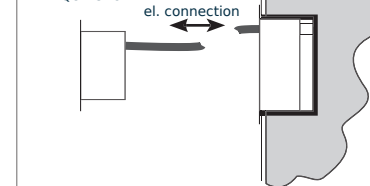

el. connection

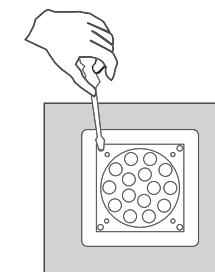

1.1.3. Make the el. connection to the luminaire part and fix it to back box with 4 screws.

1.1

### 03.3 Electrical installation



- To tackle all Safety Information- 01!
- You can suffer a dangerous electric shock by using a high voltage AC/DC power supply - by touching the AC/DC power supply wires inside LL AQUA SPOT DC 12V!
- LL AQUA SPOT DC 12V can be operated in two ways:
  - 03.3.1 LL AQUA SPOT DC 12V connecting to DC POWER SUPPLY - for switch ON/OFF luminaries
  - 03.3.2 LL AQUA SPOT DC 12V connecting to LL DRIVER - for intensity and colour control

#### 03.3.1 Connecting to PWM 12V power supply (Figure Nr. 2.1)

- LL AQUA SPOT DC 12V must be connected to the device - PWM 12V
- It is not necessary to open fixture before connecting to PWM 12V power supply.

AC Power Supply Cord plug connections to PWM Power Supply:

Symbol	Pin	Wire Colour	Screw (US)
L	live	brown	yellow or brass
N	neutral	blue	silver
	ground (earth)	yellow/green	green

#### 03.3.2 Connecting to LL DRIVER (Figure Nr. 2.2)

- For intensity and colour control is necessary connection with LL DRIVER.
- It is not necessary to open fixture before connecting to LL DRIVER.
- Before installing of LL DRIVER carefully read USER MANUAL for LL DRIVER.

## 04 MAINTENANCE



- To tackle all Safety Information- 01!
- Damage caused by inadequate cleaning or maintenance is not covered by warranty.
- Regular cleaning is demand.

#### Maintenance policy:

- Unplug mains before maintenance and at least 10 minutes cool off
- Appliance do not illegal open or demount
- Clean-up dust only from outer surface (for ex. diffuser).
- Before reinstalling to check failure-free state – no wet parts inside!

#### Basic models - monochrome

	I <sub>c</sub> (A)	Weight (kg)
LL ASPOT L160-SS-O68-18-25W-015-R-SC	1x1,05A	3,00
LL ASPOT L160-SS-O68-18-25W-015-G-SC	1x1,05A	3,00
LL ASPOT L160-SS-O68-18-25W-015-B-SC	1x1,05A	3,00
LL ASPOT L160-SS-O68-18-25W-015-A-SC	1x1,05A	3,00
LL ASPOT L160-SS-O68-18-25W-015-30K-C80	1x1,05A	3,00
LL ASPOT L160-SS-O68-18-25W-015-40K-C80	1x1,05A	3,00
LL ASPOT L160-SS-O68-18-25W-015-50K-C80	1x1,05A	3,00

#### Basic models - color

LL ASPOT L160-SS-O68-18-25W-015-RGB-SC	3x0,35A	3,00
LL ASPOT L160-SS-O68-18-25W-015-AWB-SC	3x0,35A	3,00
LL ASPOT L160-SS-O68-18-25W-015-AWN-SC	3x0,35A	3,00

#### Accessories

LL ASPOT INSTALLATION BOX

#### LL AQUA SPOT DC 12V connecting to DIN POWER SUPPLY

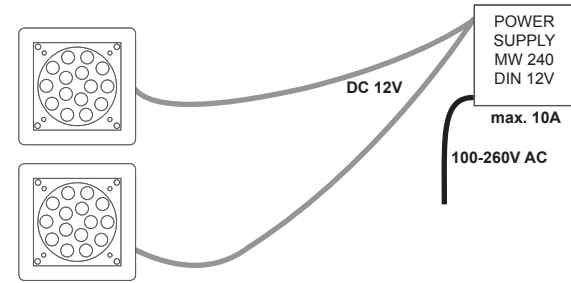

Connecting LL AQUA SPOT DC 12V to DIN POWER SUPPLY enables to switch ON/OFF luminaries.

2.1

#### LL AQUA SPOT DC 12V connecting to DRIVER and DIN POWER SUPPLY

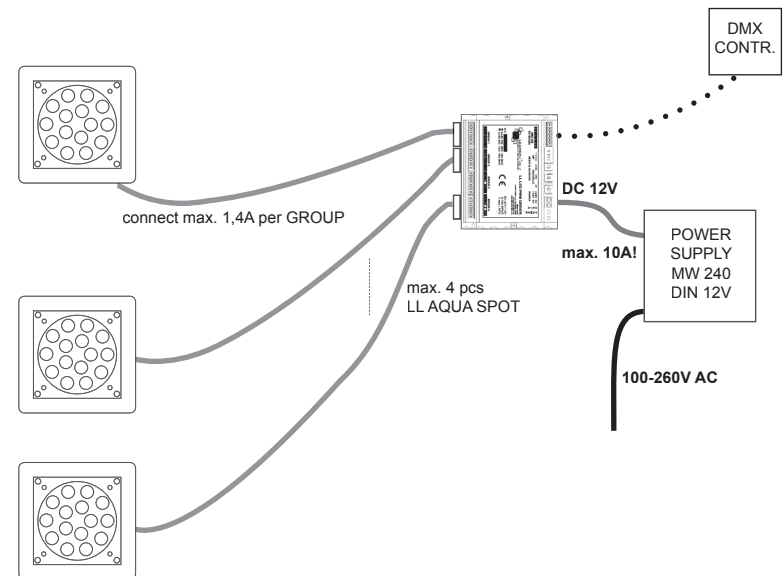

Connecting LL AQUA SPOT DC 12V to PWM DRIVER and DIN POWER SUPPLY enables to switch ON/OFF luminaries and in addition intensity and colour control by DMX controller.

2.2